



8 Stack Megatron Standard Jungle Gym (MT-SJG8)



Installation Manual

www.muscledfit.com

NOTE: In this step, all the washers and nuts which are not marked are W10 and N10

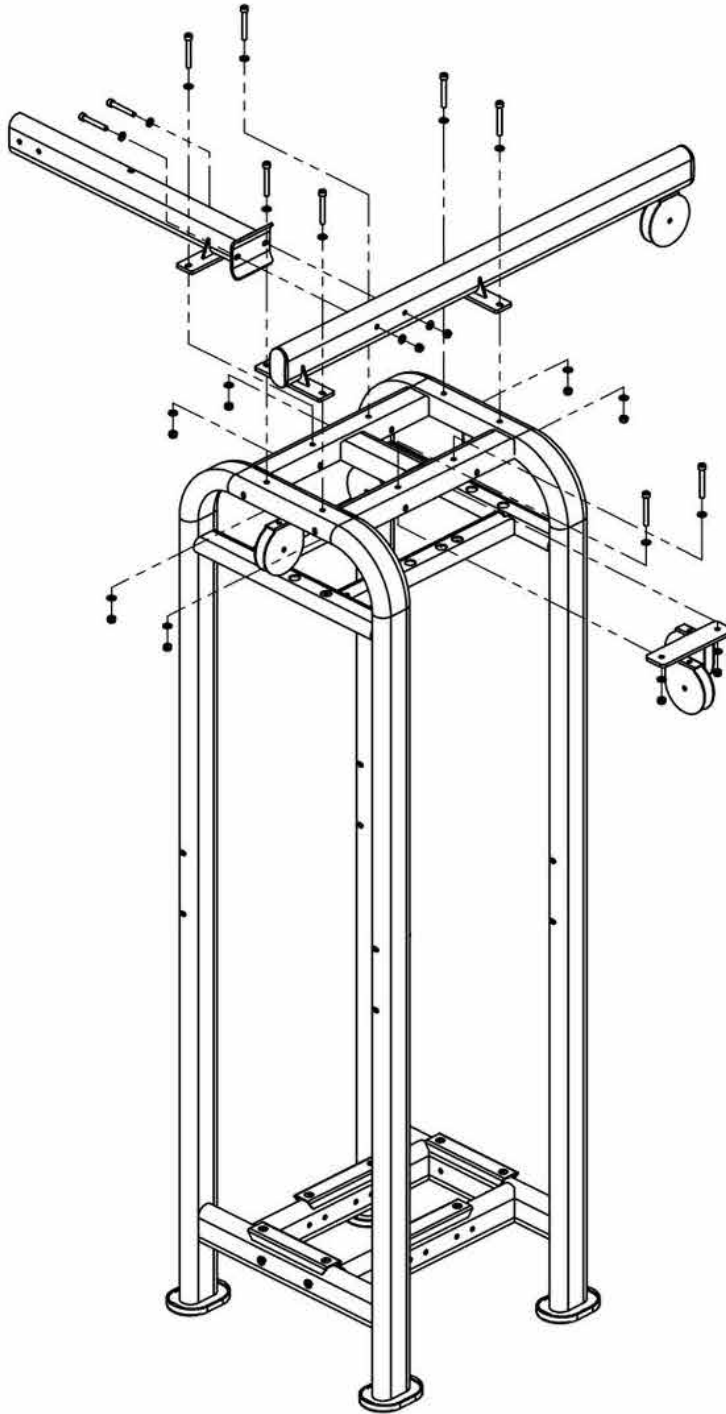

INFORMATION

- ◆ We recommend you have someone assist you in lifting and assembling your gym.
- ◆ Follow these steps carefully and it will make it easier to assemble your gym.

STEP 1

NOTE: In this step, all the washers and nuts which are not marked are W10 and N10

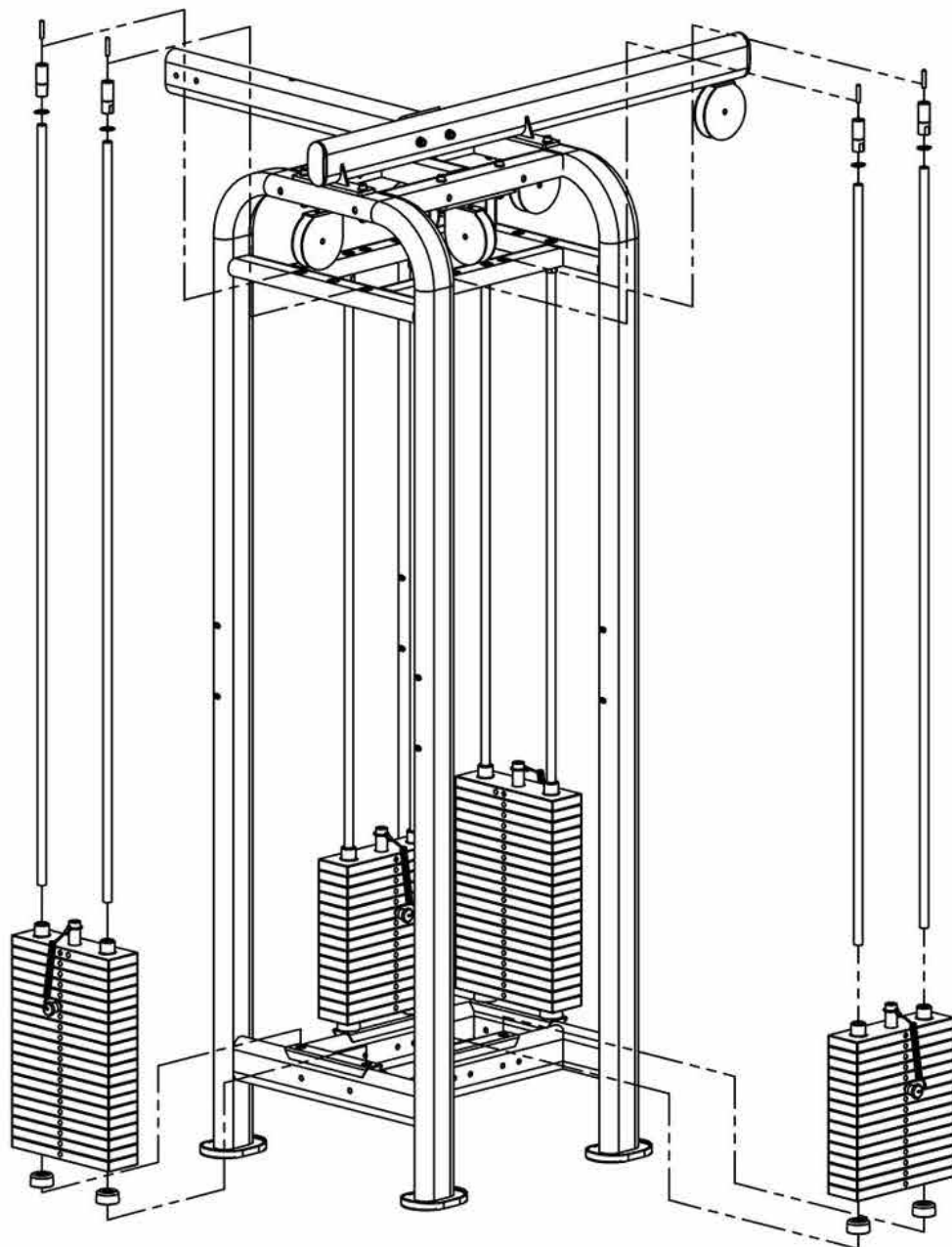

INFORMATION

- ◆ We recommend you have someone assist you in lifting and assembling your gym.
- ◆ Follow these steps carefully and it will make it easier to assemble your gym.

STEP 2

NOTE: In this step, all the washers and nuts which are not marked are W10 and N10

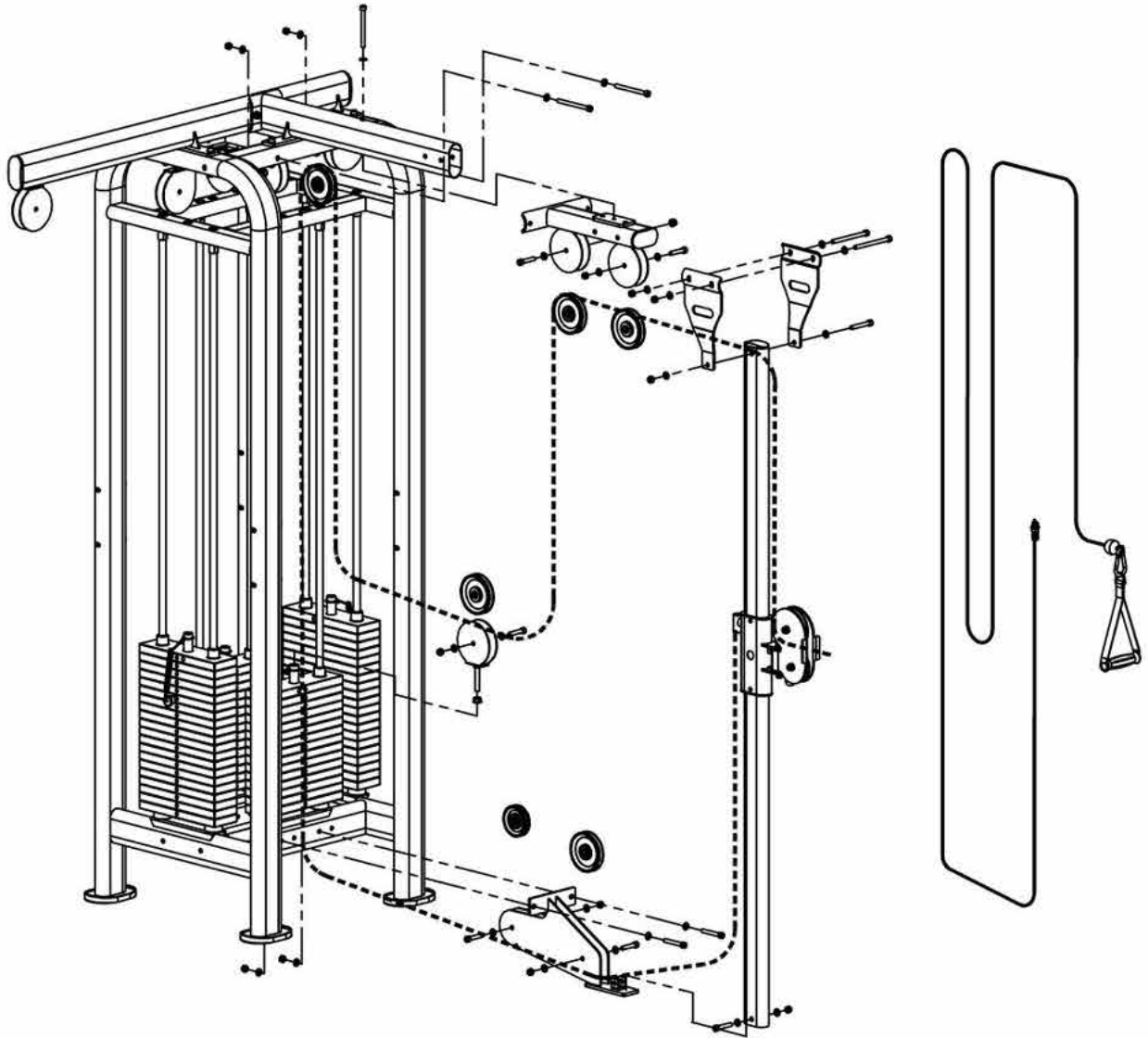

INFORMATION

- ◆ We recommend you have someone assist you in lifting and assembling your gym.
- ◆ Follow these steps carefully and it will make it easier to assemble your gym.

STEP 3

NOTE: In this step, all the washers and nuts which are not marked are W10 and N10

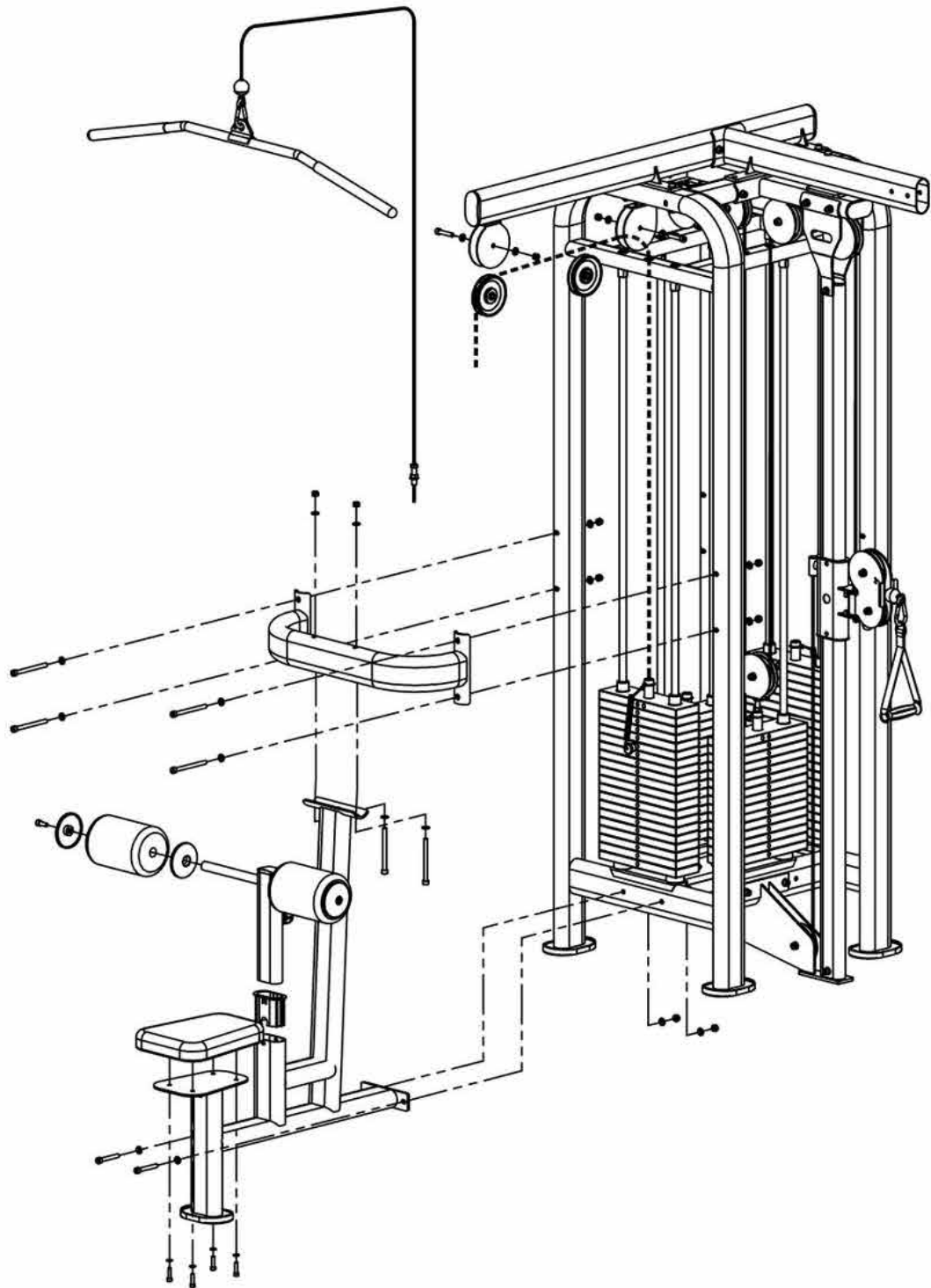

INFORMATION

- ◆ We recommend you have someone assist you in lifting and assembling your gym.
- ◆ Follow these steps carefully and it will make it easier to assemble your gym.

STEP 4

NOTE: In this step, all the washers and nuts which are not marked are W10 and N10

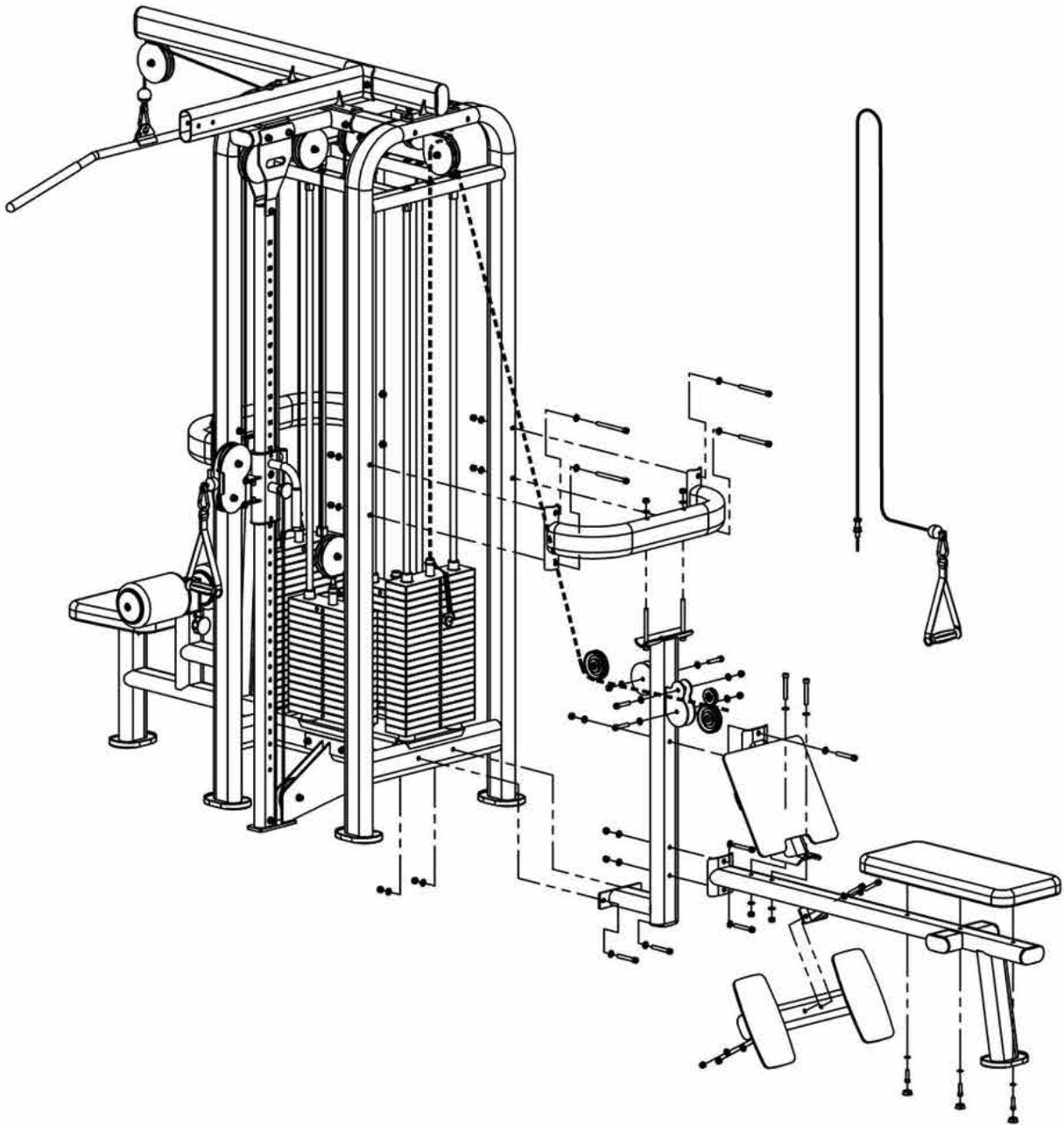

INFORMATION

- ◆ We recommend you have someone assist you in lifting and assembling your gym.
- ◆ Follow these steps carefully and it will make it easier to assemble your gym.

STEP 5

小鸟侧连接梁

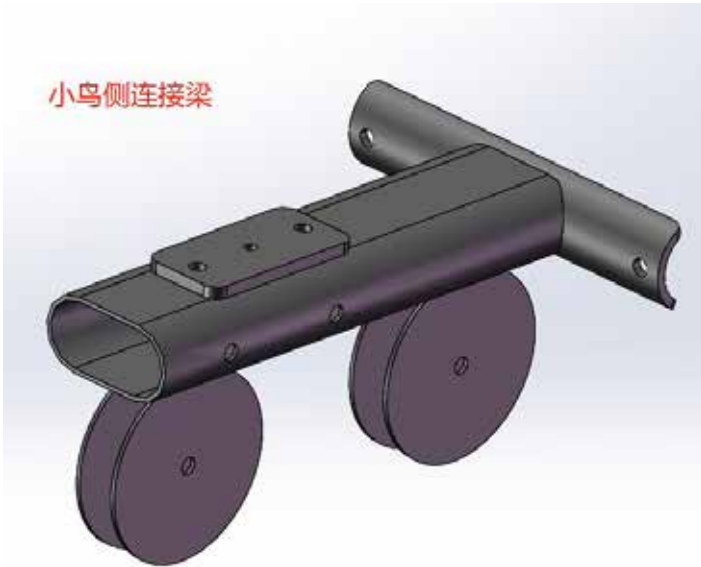

大鸟侧连接梁



Side connector A double pulley adjustment rod. Yellow, green and blue indicates side connector A.

Side connector B single pulley adjustment rod. Red connector indicates side connector B.

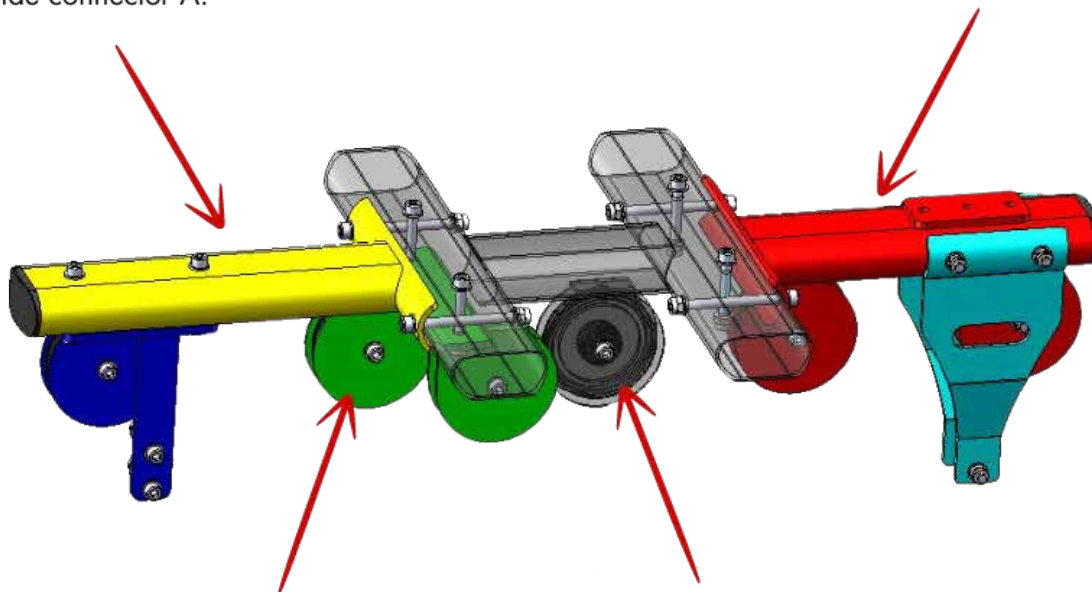

The green component is inclined toward the side connector A.

This pulley frame is welded onto the main frame and is inclined toward the side connector B.